



# Technology

Textiles

## HOW 2 Series

---

Threading the sewing  
machine



# Stage 1/10

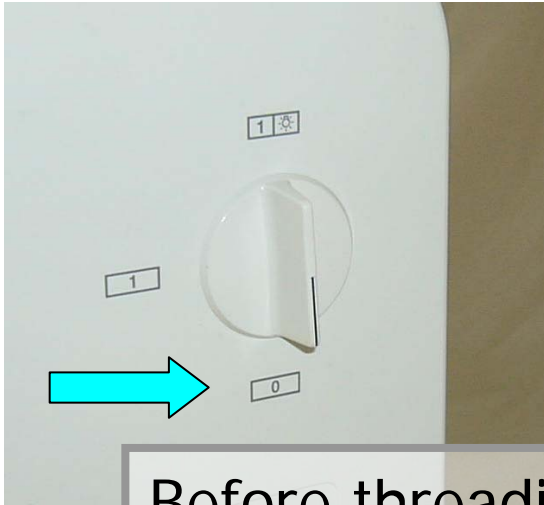

Before threading, make sure your machine is switched off at the right hand side.

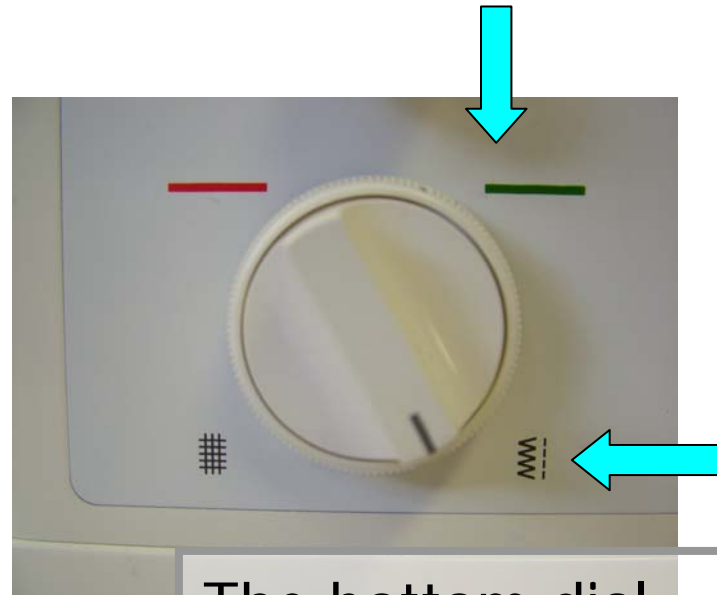

The bottom dial should always point to **green** and **zig-zag**.



## Stage 2/10

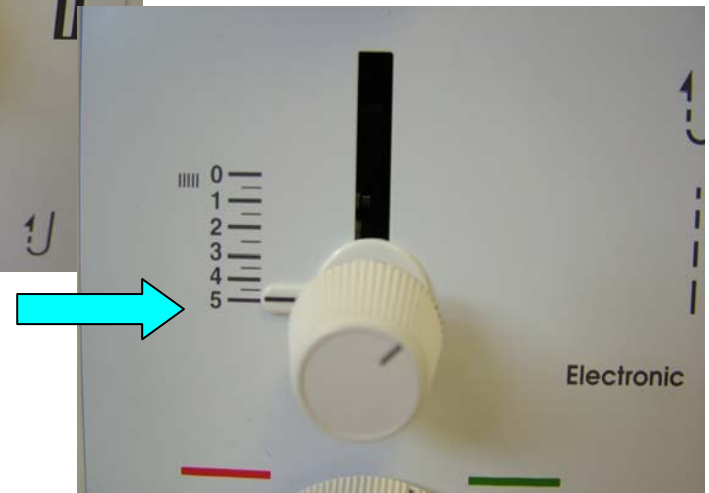
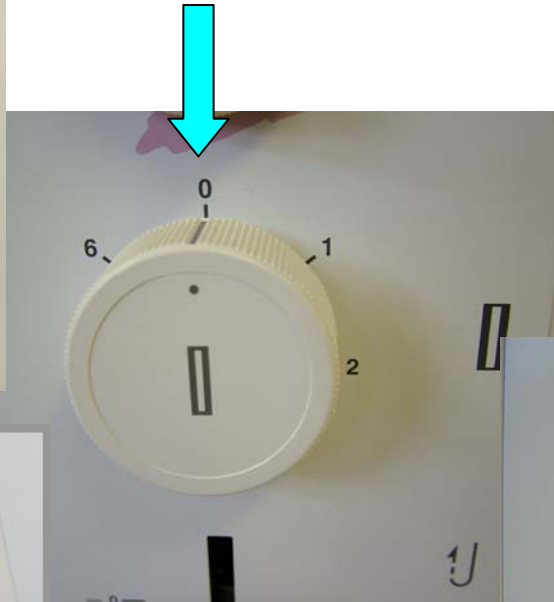
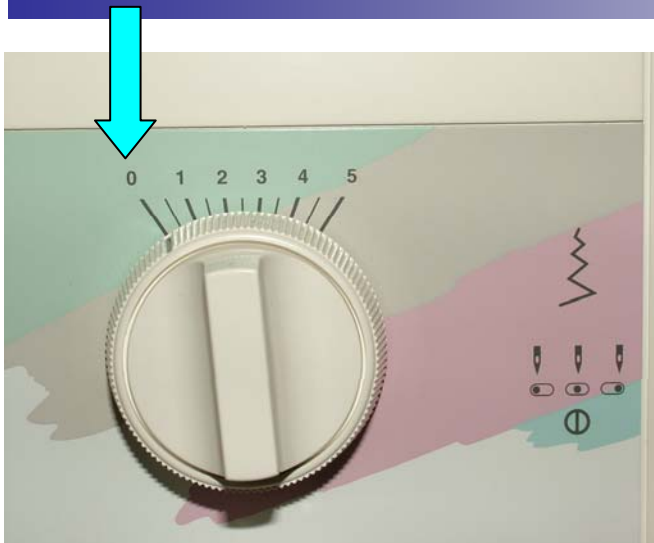

Check the settings  
on the dials at the  
front of the machine:  
remember **0-0-5**



## Stage 3/10

Place a reel of thread onto the thread holder at the top right hand side of the machine.



Pull the thread through the first thread guide, making sure it goes into the split.

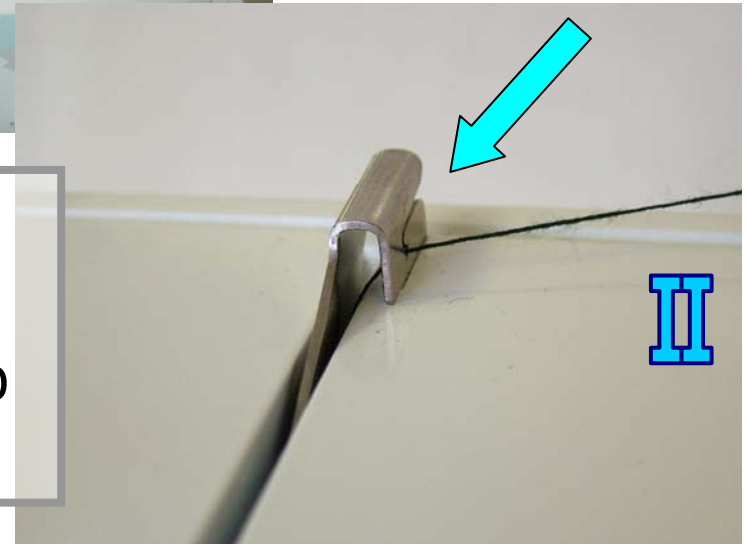



## Stage 4/10

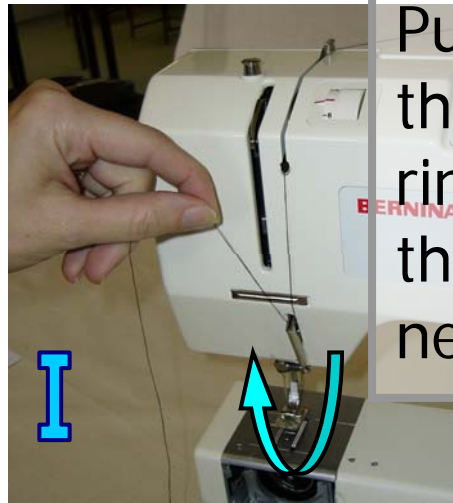

Pull the thread down through the tension rings, and around the bottom of the next thread guide.

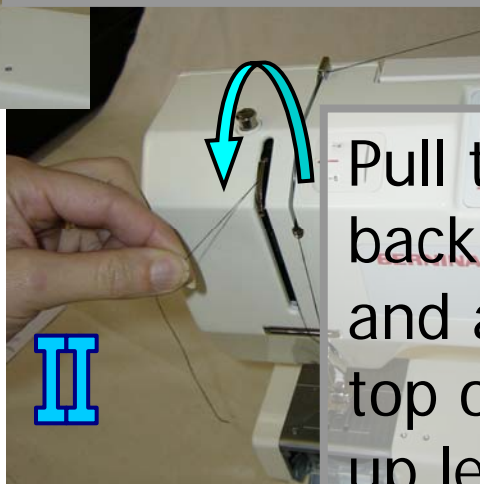

Pull the thread back upwards, and around the top of the take-up lever.

Bring the thread back downwards, and hook it behind the spring above the needle.

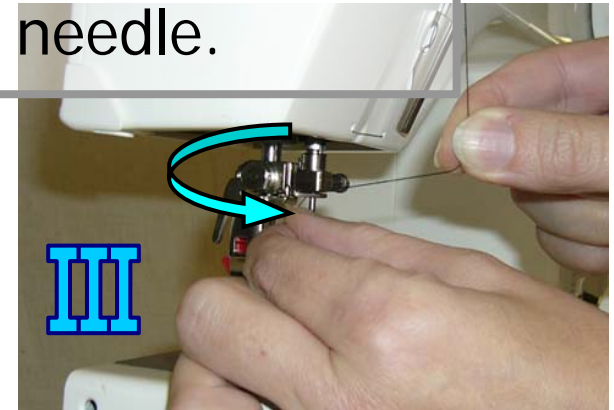



## Stage 5/10

Lower the  
presser foot,  
using the lever  
at the back of  
the machine.

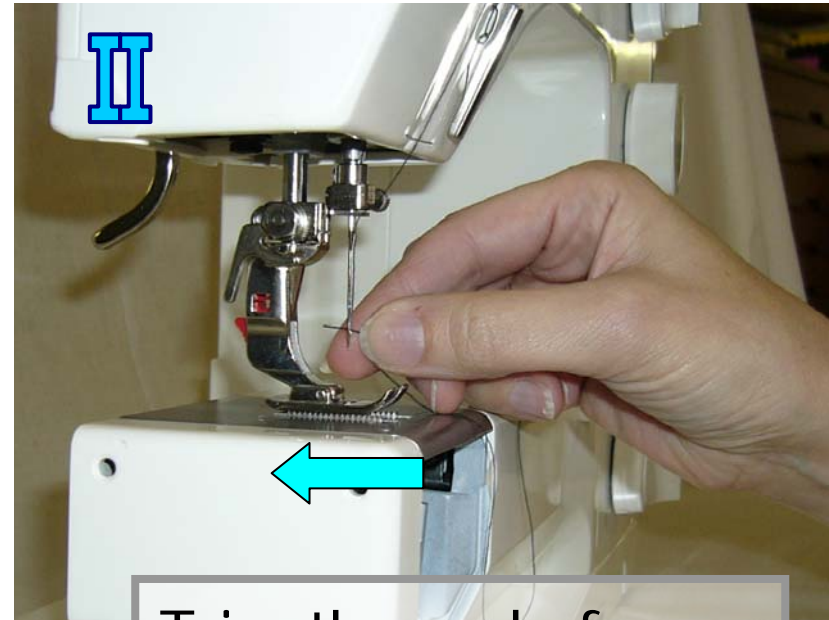
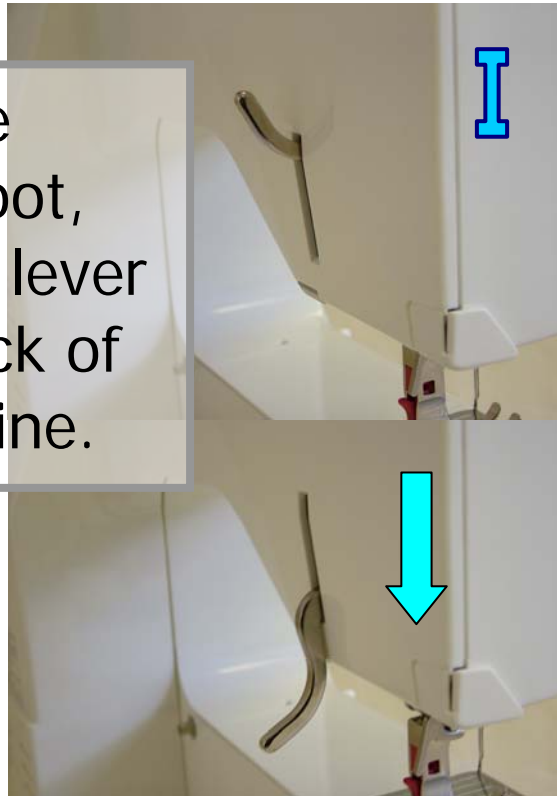

Trim the end of your  
thread neatly, and  
thread the needle  
from front to back.



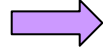

## Stage 6/10

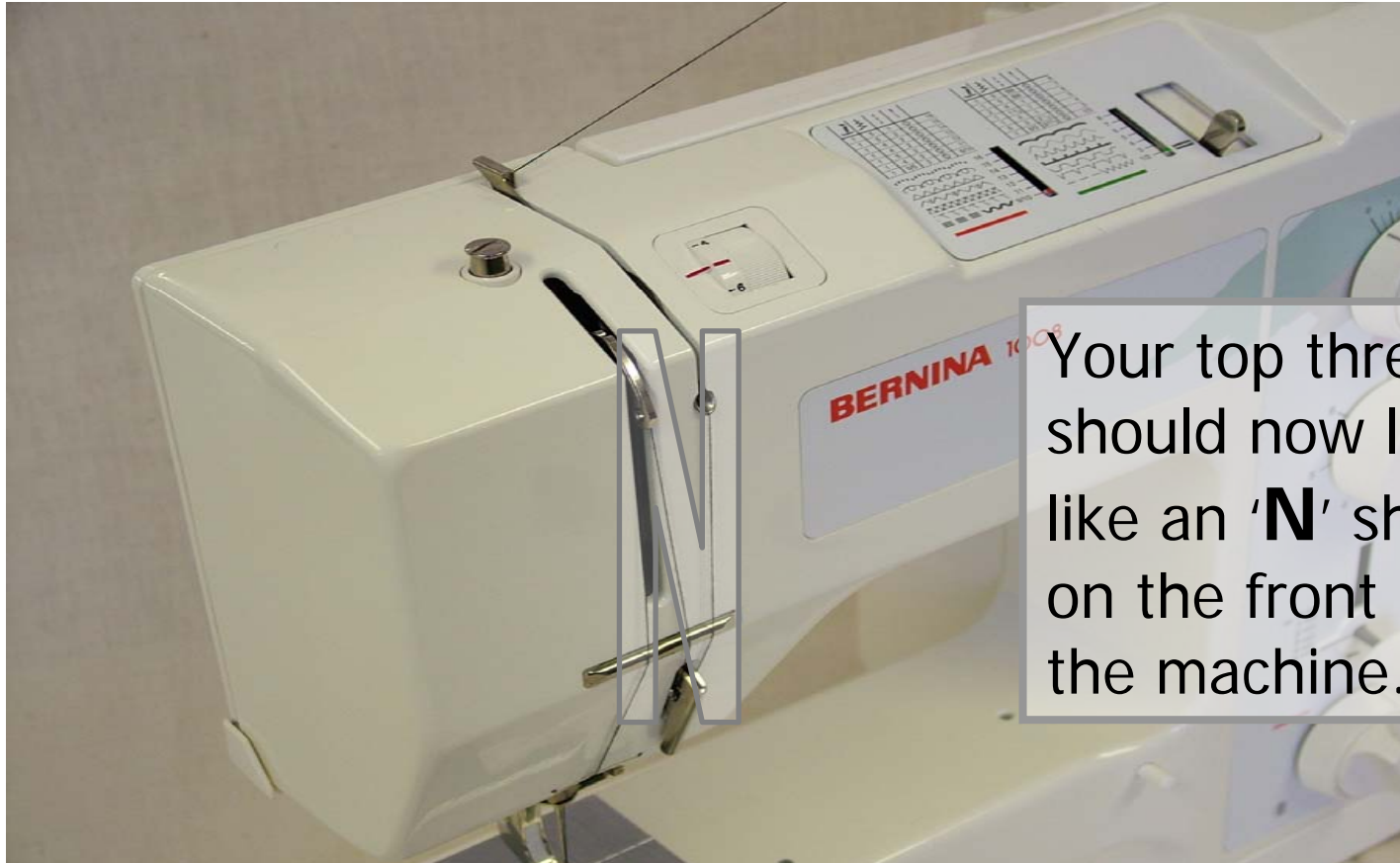

Your top thread should now look like an '**N**' shape on the front of the machine.



## Stage 7/10

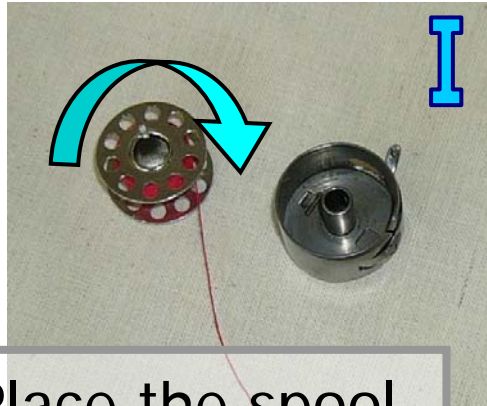

Place the spool into the spoolcase, with the thread running clockwise.



Holding the spoolcase in your left hand, pull the thread through the split and under the tension spring until it sits between the prongs.





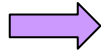

## Stage 8/10

Hold the spoolcase by pulling out the hinged lever on the back, using your right thumb and forefinger, so that the arm points upwards.

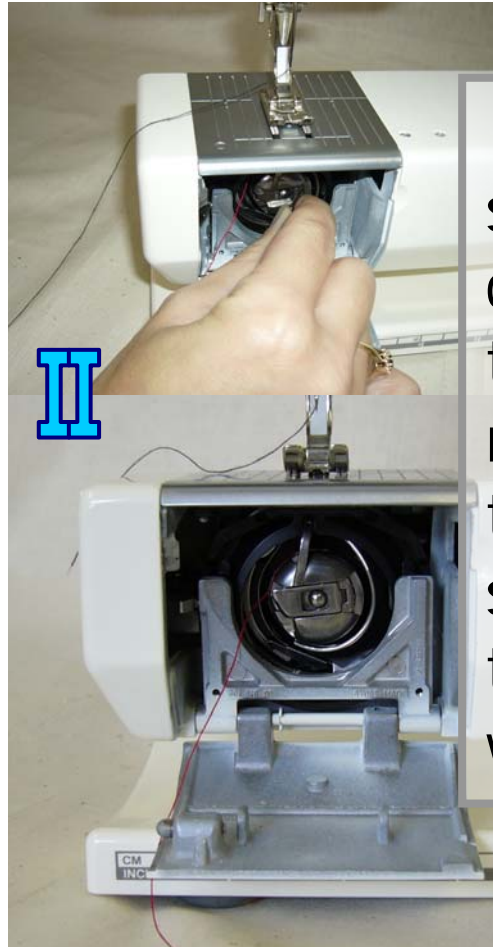

Insert the spoolcase into the compartment on the sewing machine, and click the arm into the slot at the top, so that the spoolcase will not move.



## Stage 9/10

Hold the top thread down onto the footplate with your left thumb.

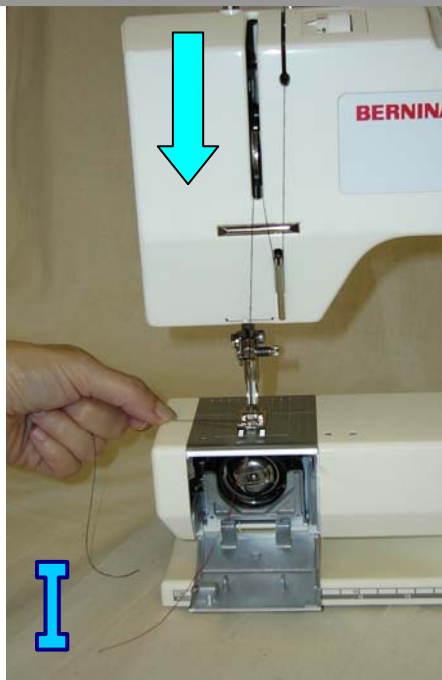

Turn the balance wheel on the right hand side of the machine toward you, so that the take-up lever moves all the way down and up once.



This will make a loop of the spool thread come up through the footplate.



# Stage 10/10



Take hold of both threads and lay them under the presser foot.

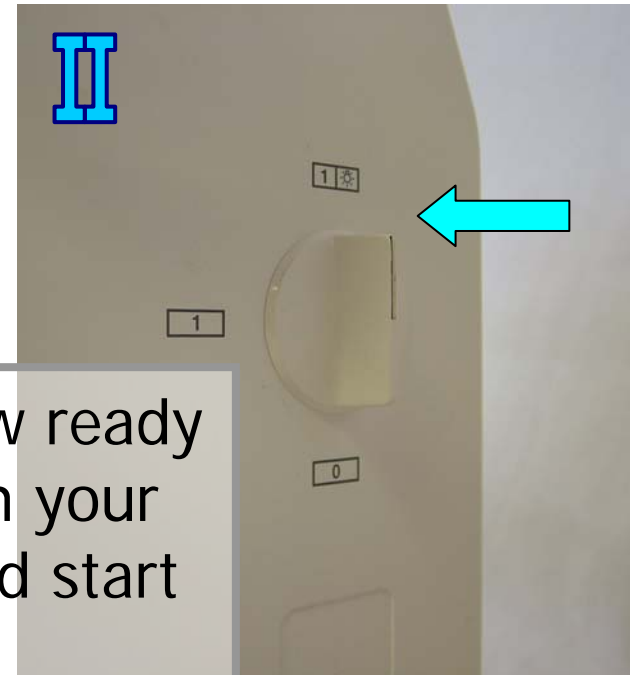

You are now ready to switch on your machine and start sewing!