

Year 7 Health & Safety

Key staff member: Richard Atkinson



Attitude to learning:

	Always	Usually	Occasionally	Rarely
Class work	1	2	3	4
Homework	1	2	3	4
Participation	1	2	3	4

Subject criteria:

Research	Ideas	Evaluation	Planning	Making

Target	Areas for Improvement	Target	Areas for Improvement
	Complete all set tasks		Annotate sketches/ideas
	Complete homework		Add colour to your sketches/ideas
	Read instructions carefully		Add more detail to your research/evaluations
	Focus on the presentation of your work		Label star diagrams & include a key
	Submit booklet on the due date		Add more detail to timeplans

Optional Comment/Target: _____

Name:

TG:

Date:

Design and Technology can be a lot of fun and you are now in an environment that is different from your normal classroom. You will be introduced and trained in the use of a whole range of tools and equipment. The very first thing you need to know is how to be safe and how to keep your friends safe.

YOU ARE RESPONSIBLE FOR THE HEALTH AND SAFETY OF YOURSELF AND YOUR FRIENDS IN TECHNOLOGY....
THIS IS HOW TO BE SAFE AND HAVE FUN IN TECHNOLOGY.

Being SAFE in D&T

A **h**_____ is anything that can cause harm or damage to you or someone



A knife in Food Technology
A soldering iron in Systems and Control
A drilling machine in Resistant Materials
A craft knife in Graphics

With all of the above there is a chance of getting hurt. This chance is called a **r**_____.
By looking at a situation you must consider if it could cause harm. This is called
a_____ the risk.

R_____ **c**_____ is an action taken to ensure that harm or danger is less likely to happen.

When you are in any area of Design and Technology and you are working on a task, think about safety and assess the *risk* before you act.

Where should you look for information to help you with risk assessment?

The best start is to ask your teacher.

Use the words below to fill in the blanks.

risk control assessing hazard risk

SIMPLE RULES:

- Never use any tool or piece of equipment you have not been trained to use.
- Do not run or rush in the Technology room.
- Tie long hair back.
- Always wear goggles when operating machines.
- ASK a teacher if you are unsure about anything.

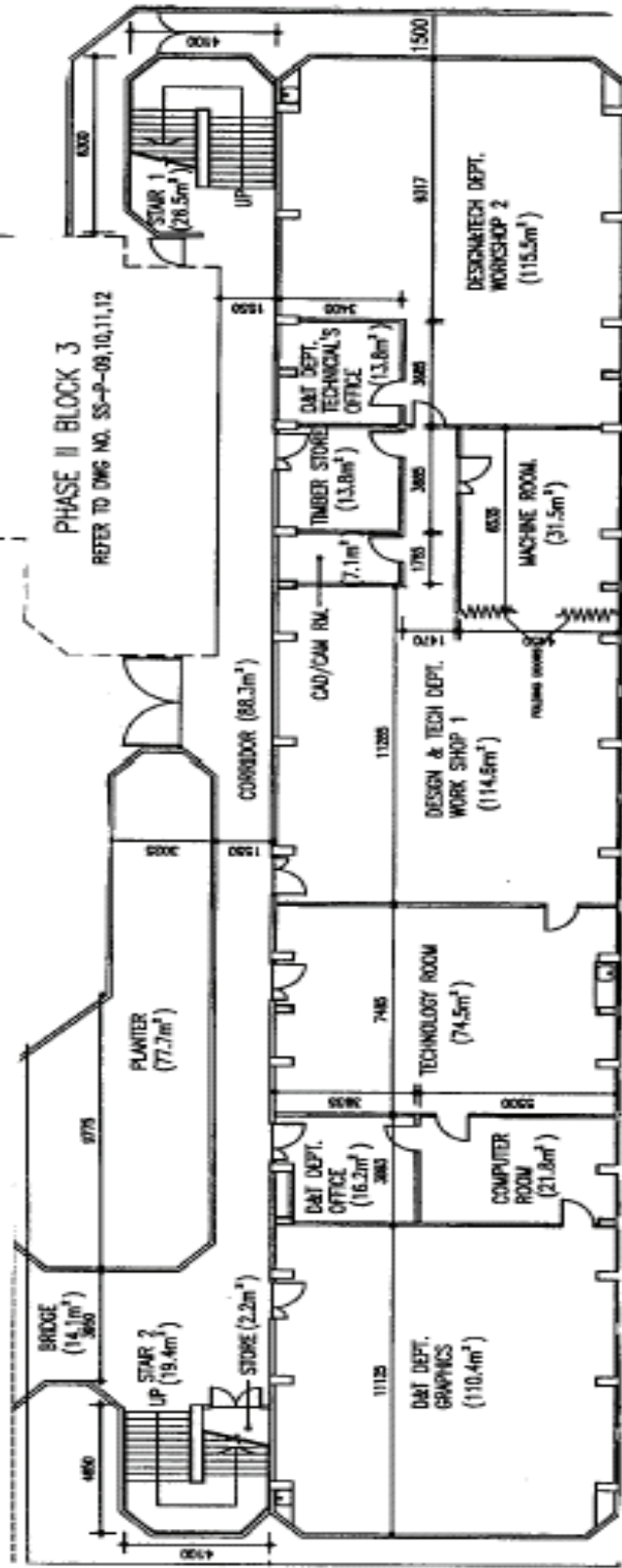

RM 209

RM 205

RM 203

RM 201

Welcome to the Technology Department at Sha Tin College.
On the map above mark the positions of:

- () Emergency exits
- () First aid boxes
- () Fire Extinguishers (fire blankets + Sand Buckets)
- () Emergency machine stops

Health and Safety

WHAT'S WRONG HERE? (8 THINGS)

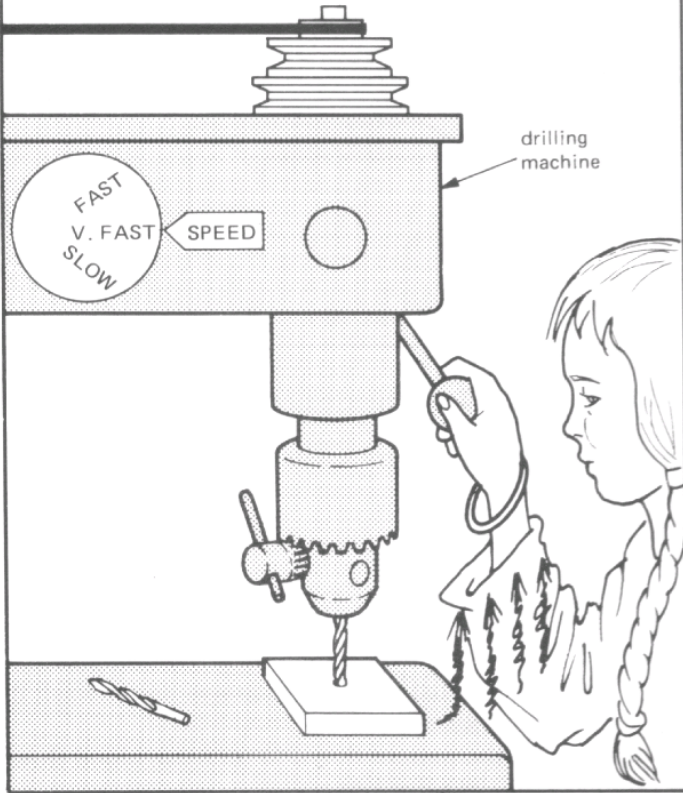

This girl has come dressed appropriately to work in the workshop. Label all the good points related to her clothing.
Can you add any further labels?
If you can add them to the picture.

- 1).....
- 2).....
- 3).....
- 4).....
- 5).....
- 6).....
- 7).....
- 8).....

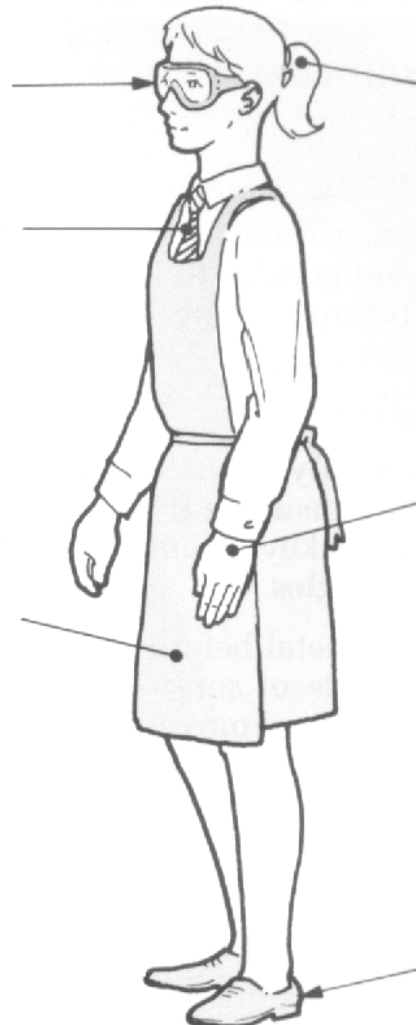

If in Doubt ask!
Never Run!
Wear eye protection
Every tool has a home

L G O G G L E S Q A Z S L A C I M E H C B U E T
 F X E G B F S V A C C I D E N T M K F T A I F E
 F I F H J U Q H P F S R S E D N L I E G N H H X
 F G R R L E M E R G E N C Y S T O P A H D S O T
 P D U S O T B U O D N T F E G O N R R D F C T R
 R X N A T I G V N U S Y Y V L O G A D C A D M A
 O Q A V R A X G G K I U F U P L H C E O C R E C
 T U C K E D I N I E B G I I R S A T F E E I T T
 E R Y U J K S D J P L E L E F G I I E G R L A I
 C H E Y R E L L E W E J M T G D R C N F I L L O
 T X I W R E D F G O R R T Y Y H J A D U S T J N
 I O M C V E R J I R R E M O V E D L E M U I S O
 O G F R L C H U C K K E Y I G K M L R E Y O D V
 N F O E A L H W A S F Q U A S X C Z S S T P R E
 D F J K A E H F O H W E I E H S W A R F R A A R
 A D S F H A N F O O L R F S A C I C I X O T Z A
 W E Q T N N B A L P T A O D R V M O Y O E S A L
 S G T O O L R A C K S Y P F P B N T N Q W D H L

Find the words below in the grid above, either ring or highlight your selections

FIRST AID	EMERGENCY STOP	PRACTICAL	CLEAN	OVERALL	EYE	SWARF
APRON	JEWELLERY	ACCIDENT	REMOVED	RUN	DANGER	DUST
SAFETY	PERMISSION	WORKSHOP	GUARDS	TOOLS	SHARP	FUMES
GOGGLES	PROTECTION	TUCKED IN	DOUBT	FOOL	TIDY	
SENSIBLE	TOOL RACKS	BAND FACER	EXTRACTION	SAFE	DRILL	
CHUCK KEY	EAR DEFENDERS	HOT METAL	CHEMICALS	HAZARDS	TOXIC	

On the back page of the booklet design a safety poster which will help students remember to be safe when working in the workshop. The poster needs to be bright and have a bold title. You could pick either one safety rule or a danger that you might encounter when completing practical work. Use the words above to help you with spelling and ideas.

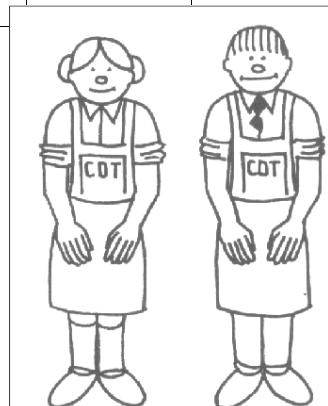

Safety Poster

Following the instructions on page 3 design a safety poster below that could be displayed in the workshop. Make sure it is attractive, interesting and colourful.

Key Skills: Basic measuring

Accurate measuring in Technology is a skill that you need to become very good at if you want your work to be accurate and well manufactured. In Technology you will use a range of different marking and measuring equipment. The first tool you need to be able to master is a steel rule or steel ruler.

A steel ruler is used in Technology because it is more robust (stronger) than a plastic one and will not be damaged in use.

You measure slightly differently with a steel ruler than you would with a plastic one.....

On a plastic ruler you start measuring from 0 which is approximately 5mm in from the end. On a steel ruler you measure right from the end. This is so that you can measure directly from a flat surface.

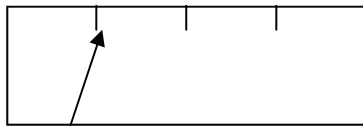

Plastic ruler Start here

Use a steel ruler to measure the length of the lines below and write in mm at the end.

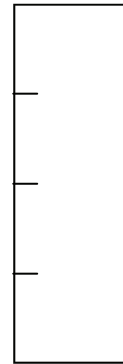

Steel ruler Start here

Measure the perimeter of the shape below

